

AERODROME OBSTACLE CHART - ICAO TYPE B

SHARJAH / INTL
UNITED ARAB EMIRATES

ARP 251945N
0553058E

AD ELEV 119 FT

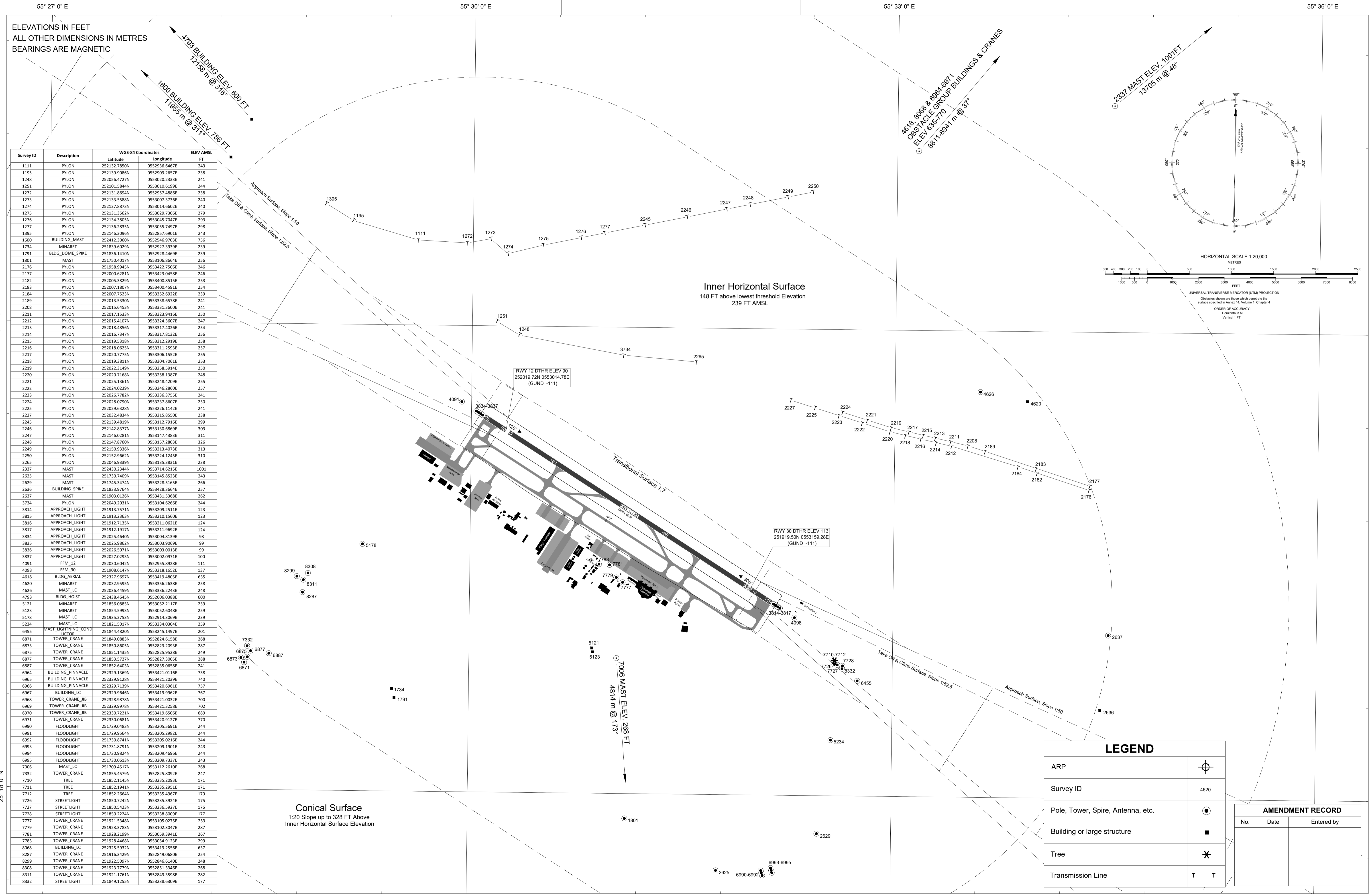

ELEVATIONS IN FEET
ALL OTHER DIMENSIONS IN METRES
BEARINGS ARE MAGNETIC

Survey ID	Description	WGS-84 Coordinates		ELEV AMSL
		Latitude	Longitude	FT
1111	PYLON	252132.7850N	0552936.6467E	243
1195	PYLON	252139.9086N	0552909.2657E	238
1248	PYLON	252056.4727N	0553020.2333E	241
1251	PYLON	252101.5944N	0553010.5199E	244
1272	PYLON	252131.8694N	0552957.4886E	238
1273	PYLON	252133.5588N	0553007.3736E	240
1274	PYLON	252127.8873N	0553014.6602E	240
1275	PYLON	252131.3562N	0553029.7306E	279
1276	PYLON	252134.3805N	0553045.7047E	293
1277	PYLON	252136.2835N	0553055.7497E	298
1395	PYLON	252146.3096N	0552857.6901E	243
1600	BUILDING_MAST	252412.3060N	0552546.9703E	756
1734	MINARET	251839.8029N	0552927.3939E	239
1791	BLDG_DOME_SPIKE	251836.1410N	0552928.4469E	239
1801	MAST	251750.4017N	0553106.8664E	256
2176	PYLON	251958.9945N	0553422.7506E	246
2177	PYLON	252000.6281N	0553423.0458E	246
2182	PYLON	252005.3829N	0553400.8515E	253
2183	PYLON	252007.1807N	0553400.4591E	254
2184	PYLON	252007.7523N	0553352.6922E	239
2189	PYLON	252013.5330N	0553338.6578E	241
2208	PYLON	252015.6453N	0553331.3606E	241
2211	PYLON	252017.1533N	0553323.9416E	250
2212	PYLON	252015.4107N	0553324.3607E	247
2213	PYLON	252018.4856N	0553317.4026E	254
2214	PYLON	252016.7347N	0553317.8132E	256
2215	PYLON	252019.5318N	0553312.2919E	258
2216	PYLON	252018.0625N	0553311.2593E	257
2217	PYLON	252020.7775N	0553306.1552E	255
2218	PYLON	252019.3811N	0553304.7061E	253
2219	PYLON	252022.3149N	0553258.5914E	250
2220	PYLON	252020.7168N	0553258.1387E	248
2221	PYLON	252025.1361N	0553248.4209E	255
2222	PYLON	252024.0239N	0553246.2860E	257
2223	PYLON	252026.7782N	0553236.3755E	241
2224	PYLON	252028.0790N	0553237.8607E	250
2225	PYLON	252029.6328N	0553226.1142E	241
2227	PYLON	252032.4834N	0553215.8550E	238
2245	PYLON	252139.4819N	0553112.7916E	299
2246	PYLON	252142.8777N	0553130.6899E	303
2247	PYLON	252146.0281N	0553147.4383E	311
2248	PYLON	252147.8760N	0553157.2803E	326
2249	PYLON	252150.9336N	0553213.4073E	313
2250	PYLON	252152.9662N	0553224.1245E	310
2265	PYLON	252046.9339N	0553135.3831E	238
2337	MAST	252430.2344N	0553734.6215E	1001
2625	MAST	251730.7409N	0553145.8523E	243
2629	MAST	251745.3474N	0553228.5165E	266
2636	BUILDING_SPIKE	251833.9764N	0553428.3646E	257
2637	MAST	251903.0126N	0553431.5368E	262
3734	PYLON	252049.2031N	0553104.6266E	244
3814	APPROACH_LIGHT	251913.7571N	0553209.2511E	123
3815	APPROACH_LIGHT	251913.2363N	0553210.1560E	123
3816	APPROACH_LIGHT	251912.7135N	0553211.0621E	124
3817	APPROACH_LIGHT	251912.1917N	0553211.9692E	124
3834	APPROACH_LIGHT	252025.9640N	0553004.8139E	98
3835	APPROACH_LIGHT	252025.9862N	0553003.9099E	99
3836	APPROACH_LIGHT	252025.5071N	0553001.0013E	99
3837	APPROACH_LIGHT	252027.0293N	0553002.0971E	100
4091	FFM_12	252030.6042N	0552955.8928E	111
4098	FFM_30	251908.6147N	0553218.1652E	137
4618	BLDG_AERIAL	252327.9697N	0553419.4805E	635
4620	MINARET	252032.9595N	0553356.2638E	258
4626	MAST_LC	252036.4459N	0553336.2243E	248
4793	BLDG_HOIST	252438.4645N	0552606.0388E	600
5121	MINARET	251856.0885N	0553052.2117E	259
5123	MINARET	251854.5993N	0553052.6046E	259
5178	MAST_LC	251935.2753N	0552914.3069E	239
5234	MAST_LC	251821.5017N	0553234.0304E	259
6455	MAST_LIGHTNING_COND	251844.4820N	0553245.1497E	201
6871	TOWER_CRANE	251849.0883N	0552824.6158E	268
6873	TOWER_CRANE	251850.8605N	0552823.2093E	287
6875	TOWER_CRANE	251851.1435N	0552825.9528E	249
6877	TOWER_CRANE	251853.5727N	0552827.3005E	288
6887	TOWER_CRANE	251852.6403N	0552835.0658E	241
6964	BUILDING_PINNACLE	252329.1369N	0553421.0116E	738
6965	BUILDING_PINNACLE	252329.9128N	0553421.2039E	740
6966	BUILDING_PINNACLE	252329.7139N	0553420.6961E	757
6967	BUILDING_LC	252329.9646N	0553419.9962E	767
6968	TOWER_CRANE_JIB	252328.9878N	0553421.0032E	700
6969	TOWER_CRANE_JIB	252329.9978N	0553421.3258E	702
6970	TOWER_CRANE_JIB	252330.7221N	0553419.6506E	689
6971	TOWER_CRANE	252330.0681N	0553420.9127E	770
6990	FLOODLIGHT	251729.0483N	0553205.5691E	244
6991	FLOODLIGHT	251729.9564N	0553205.2982E	244
6992	FLOODLIGHT	251730.8741N	0553205.0216E	244
6993	FLOODLIGHT	251731.8791N	0553206.1901E	243
6994	FLOODLIGHT	251730.9824N	0553209.4696E	244
6995	FLOODLIGHT	251730.0613N	0553209.7337E	243
7006	MAST_LC	251709.4517N	0553112.2610E	268
7332	TOWER_CRANE	251855.4579N	0552825.8092E	247
7710	TREE	251852.1145N	0553235.2093E	171
7711	TREE	251852.1941N	0553235.2951E	171
7712	TREE	251852.2664N	0553235.4967E	170
7726	STREETLIGHT	251850.7242N	0553235.3924E	175
7727	STREETLIGHT	251850.5423N	0553236.5972E	176
7728	STREETLIGHT	251850.2244N	0553238.8009E	177
7777	TOWER_CRANE	251921.5348N	0553105.0275E	253
7779	TOWER_CRANE	251923.3783N	0553102.3047E	287
7781	TOWER_CRANE	251928.2199N	0553059.3941E	267
7783	TOWER_CRANE	251928.4468N	0553054.9123E	299
8068	BUILDING_LC	252325.5932N	0553419.2556E	637
8287	TOWER_CRANE	251916.3429N	0552849.0680E	254
8299	TOWER_CRANE	251922.5097N	0552846.6140E	248
8308	TOWER_CRANE	251923.7798N	0552851.3346E	268
8311	TOWER_CRANE	251921.1761N	0552849.3598E	282
8332	STREETLIGHT	251849.1255N	0553238.6309E	177

LEGEND

ARP	⊕
Survey ID	4620
Pole, Tower, Spire, Antenna, etc.	●
Building or large structure	■
Tree	*
Transmission Line	-T-T-

AMENDMENT RECORD

No.	Date	Entered by

CHANGES: Updated Obstacles. Editorial.