

ANNUAL RATE OF CHANGE 0.05° E  
VAR 2° E (2025)

ELEVATIONS IN FEET  
DIMENSIONS IN METRES  
BEARINGS ARE MAGNETIC

LEGEND	
APRON	
STAND NR	36

ATS COMMUNICATION FACILITIES			
Service	Call Sign	Channel (MHz)	Remarks
APP	DUBAI DEPARTURES NORTH	PRI 124.675	EMERG 121.500 MHz
		SRY 120.250	
	DUBAI DEPARTURES SOUTH	PRI 121.025	
		SRY 120.250	
TWR	SHARJAH TOWER	118.600	
GND	SHARJAH GROUND	121.875	
ATIS	SHARJAH INTERNATIONAL AIRPORT	122.400	

APRON PHYSICAL CHARACTERISTICS		
Apron	Stands	Strength (PCR) and Surface
MAIN APRON	1A - 1C	954/F/A/W/T Concrete (Interlock Pavers)
MAIN APRON	2 - 8	1424/R/C/W/T Concrete
EASTERN APRON	9, 10, 11, 14	1221/F/A/W/T Concrete (Interlock Pavers)
EASTERN APRON	13	1577/F/D/W/T Concrete (Interlock Pavers)
EASTERN APRON	15 - 26	954/F/C/W/T Concrete (Interlock Pavers)
WESTERN APRON	29 - 40	940/F/B/W/T Concrete (Interlock Pavers)
CARGO APRON	50 - 62	1428/R/C/W/T Concrete
MAINTENANCE APRON	80 - 84	1577/F/D/W/T Concrete (Interlock Pavers)
MAINTENANCE AREA	F1 and F2	1108/R/D/W/T Concrete
SERVICE AREA		1428/R/C/W/T Concrete
VIP APRON		900/R/A/W/T Concrete

MAIN APRON				
Stand	Latitude	Longitude	Elevation (FT)	Code
1A	251918.79N	0553125.32E	100.0	C
1B	251917.55N	0553124.46E	101.1	C
1C	251916.32N	0553123.60E	102.2	C
2	251917.93N	0553120.70E	100.9	C
3	251919.16N	0553118.59E	100.0	E
4	251920.47N	0553116.54E	99.0	C
5	251921.59N	0553114.36E	98.2	E
6	251922.89N	0553112.33E	96.8	D
7	251923.82N	0553110.04E	94.6	E
8	251925.30N	0553108.15E	92.0	D

EASTERN APRON				
Stand	Latitude	Longitude	Elevation (FT)	Code
9	251930.27N	0553105.51E	89.5	C
10	251929.03N	0553104.76E	90.4	C
11	251927.83N	0553103.93E	90.5	C
13	251931.14N	0553104.01E	89.5	C
14	251933.73N	0553059.50E	89.5	C
15	251929.94N	0553103.18E	90.4	C
16	251932.49N	0553058.75E	90.3	C
17	251928.75N	0553102.35E	90.5	C
18	251931.30N	0553057.92E	90.3	C
21	251934.60N	0553058.00E	89.5	C
22	251937.08N	0553053.68E	89.6	C
23	251933.40N	0553057.17E	90.2	C
24	251935.89N	0553052.84E	89.6	C
25	251932.21N	0553056.34E	90.3	C
26	251934.69N	0553052.01E	89.6	C

WESTERN APRON				
Stand	Latitude	Longitude	Elevation (FT)	Code
29	251944.49N	0553041.05E	77.3	C
30	251947.04N	0553036.64E	77.3	C
31	251943.26N	0553040.19E	78.6	C
32	251945.80N	0553035.77E	78.6	C
33	251942.02N	0553039.33E	80.0	C
34	251944.57N	0553034.91E	80.0	C
35	251947.97N	0553035.01E	77.6	C
36	251950.52N	0553030.59E	77.3	C
37	251946.74N	0553034.15E	78.6	C
38	251949.28N	0553029.73E	78.2	C
39	251945.50N	0553033.29E	79.5	C
40	251948.05N	0553028.87E	79.1	C

CARGO APRON				
Stand	Latitude	Longitude	Elevation (FT)	Code
50	251935.67N	0553043.94E	84.9	E
51	251939.80N	0553037.15E	81.1	E
52	251933.90N	0553042.33E	84.7	D
53	251937.75N	0553035.63E	81.0	E
54	251932.20N	0553041.28E	84.8	D
55	251935.60N	0553034.29E	81.1	E
56	251930.65N	0553040.00E	84.7	D
57	251933.63N	0553033.00E	81.6	E- Rest
58	251929.02N	0553038.86E	84.7	D
59	251931.73N	0553031.58E	81.6	E
60	251927.28N	0553037.90E	84.8	D
61	251929.73N	0553030.20E	81.2	E
62	251925.75N	0553036.58E	84.8	D

MAINTENANCE APRON				
Stand	Latitude	Longitude	Elevation (FT)	Code
80	252012.60N	0552951.41E	80.3	F
81	252013.99N	0552948.99E	80.1	E
81A	252014.12N	0552948.78E	80.0	F
82	252014.97N	0552946.88E	80.0	D
83	252016.00N	0552945.08E	79.9	D
84	252017.04N	0552943.29E	79.8	D

MAINTENANCE AREA				
Stand	Latitude	Longitude	Elevation (FT)	Code
F1	252002.32N	0552948.70E	88.1	F
F2	252000.58N	0552951.73E	90.5	F

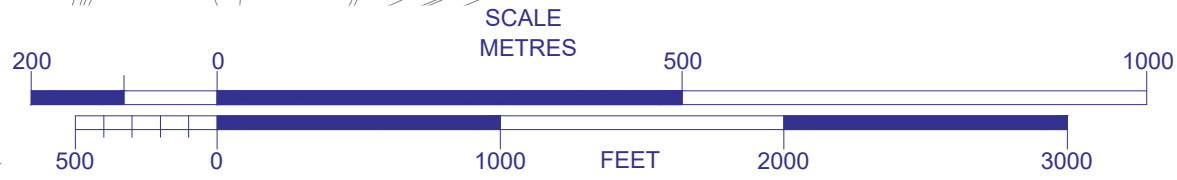
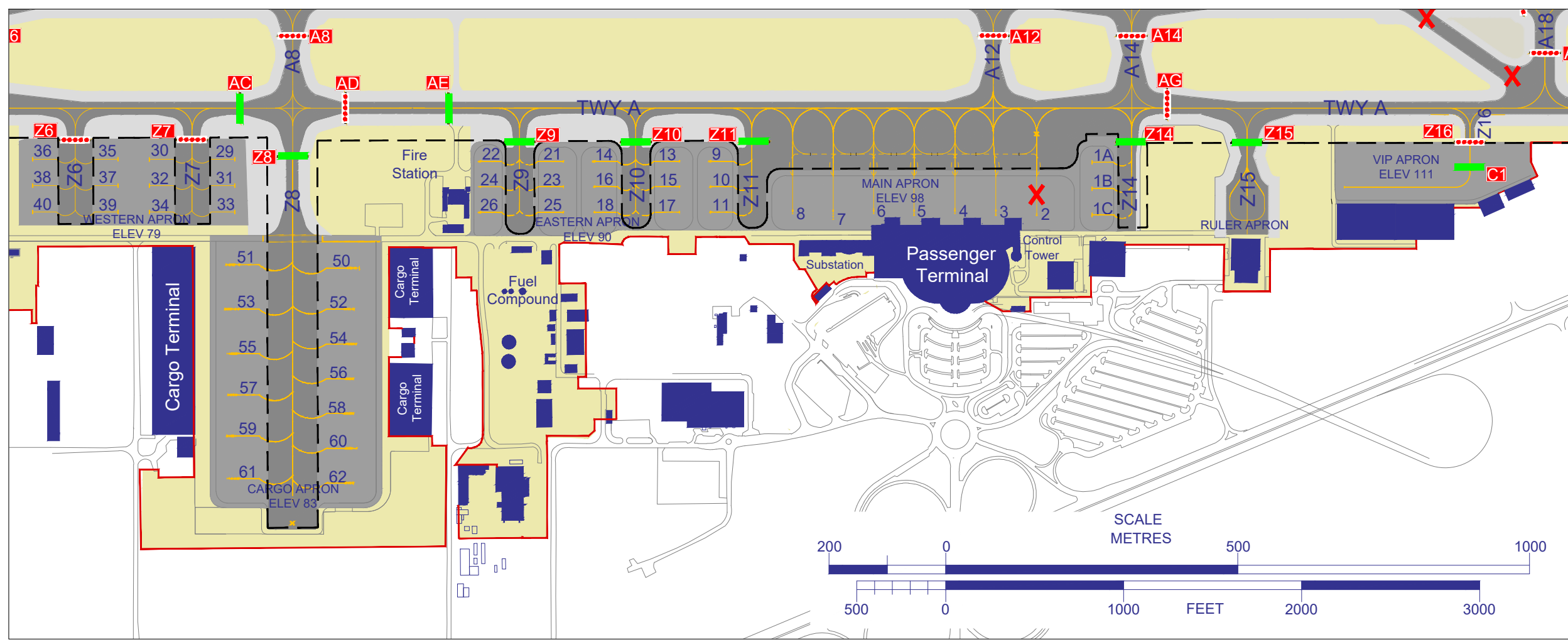

CHANGES: Amended Eastern Apron, Main Apron ELEV, Stands 55 & 61, COORD., ELEV. Updated base map.