

ARP 251510N 0552152E
 AD ELEV 62 FT

APRON FOXTROT and APRON BRAVO

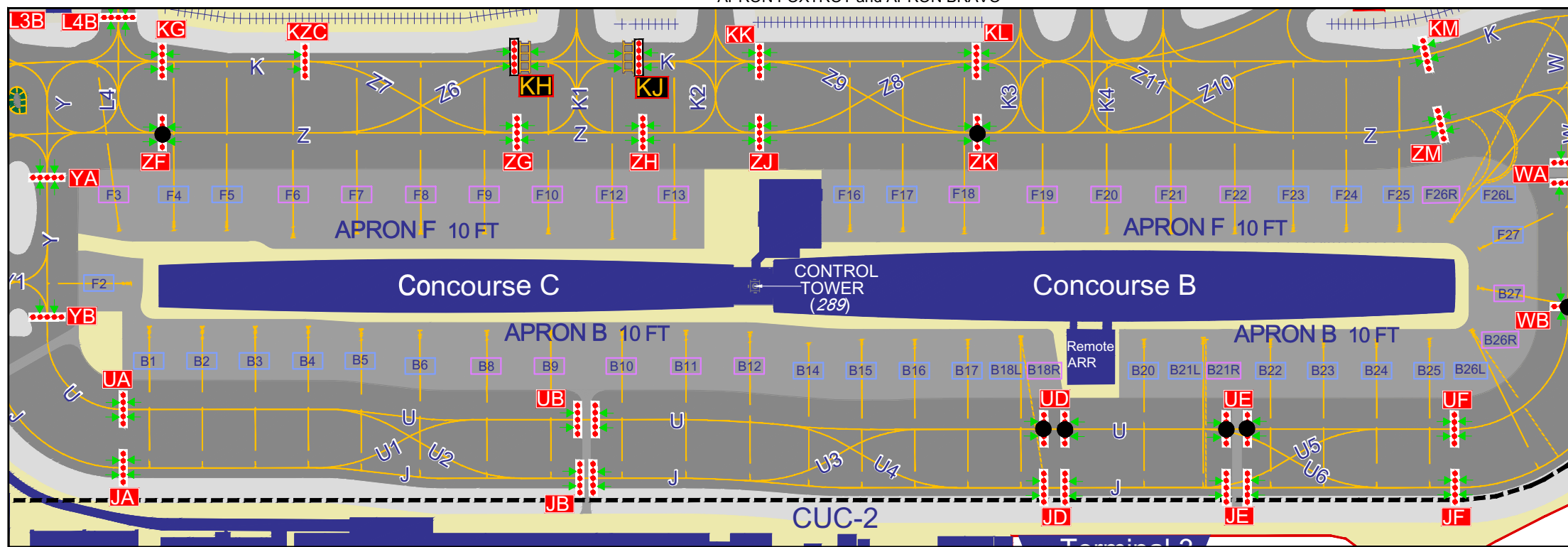

APRON FOXTROT			
STAND	LATITUDE	LONGITUDE	ELEV (FT)
F2	251516.92N	0552101.44E	7.9
F3	251519.19N	0552102.28E	7.6
F4	251517.94N	0552104.57E	7.8
F5	251516.72N	0552106.78E	7.8
F6	251514.91N	0552109.37E	8.0
F7	251513.59N	0552112.13E	7.8
F8	251512.11N	0552114.79E	7.9
F9	251510.63N	0552117.45E	7.9
F10	251509.16N	0552120.12E	7.9
F12	251507.47N	0552122.64E	8.0
F13	251506.04N	0552125.23E	8.0
F16	251502.27N	0552132.75E	8.6
F17	251501.04N	0552134.96E	10.7
F18	251459.54N	0552137.47E	12.9
F19	251457.73N	0552140.74E	12.9
F20	251456.25N	0552143.41E	13.0
F21	251454.77N	0552146.08E	12.9
F22	251453.29N	0552148.75E	12.9
F23	251452.01N	0552151.25E	12.9
F24	251450.79N	0552153.46E	12.9
F25	251449.56N	0552155.67E	12.9
F26L	251448.75N	0552158.12E	12.4
F26R	251448.74N	0552158.05E	12.5
F27	251447.05N	0552158.55E	12.7

APRON BRAVO			
STAND	LATITUDE	LONGITUDE	ELEV (FT)
B1	251514.86N	0552101.11E	8.2
B2	251513.64N	0552103.32E	8.2
B3	251512.42N	0552105.53E	8.1
B4	251511.19N	0552107.74E	8.1
B5	251509.87N	0552109.88E	8.1
B6	251508.46N	0552112.30E	8.1
B8	251506.90N	0552115.08E	7.7
B9	251505.42N	0552117.75E	7.2
B10	251503.78N	0552120.72E	7.2
B11	251502.30N	0552123.39E	7.3
B12	251500.76N	0552126.02E	7.1
B14	251458.99N	0552128.20E	7.2
B15	251457.90N	0552130.50E	9.1
B16	251456.67N	0552132.71E	11.5
B17	251455.45N	0552134.92E	12.6
B18L	251454.35N	0552137.22E	12.7
B18R	251454.30N	0552137.19E	12.7
B20	251451.37N	0552142.28E	12.7
B21L	251450.07N	0552144.79E	12.6
B21R	251449.93N	0552144.85E	12.6
B22	251448.45N	0552147.55E	12.7
B23	251447.22N	0552149.76E	12.7
B24	251445.99N	0552151.97E	12.7
B25	251444.80N	0552154.20E	12.7
B26L	251444.17N	0552156.16E	12.8
B26R	251444.06N	0552156.19E	12.6
B27	251445.61N	0552157.50E	12.8

APRON ALPHA and APRON DELTA

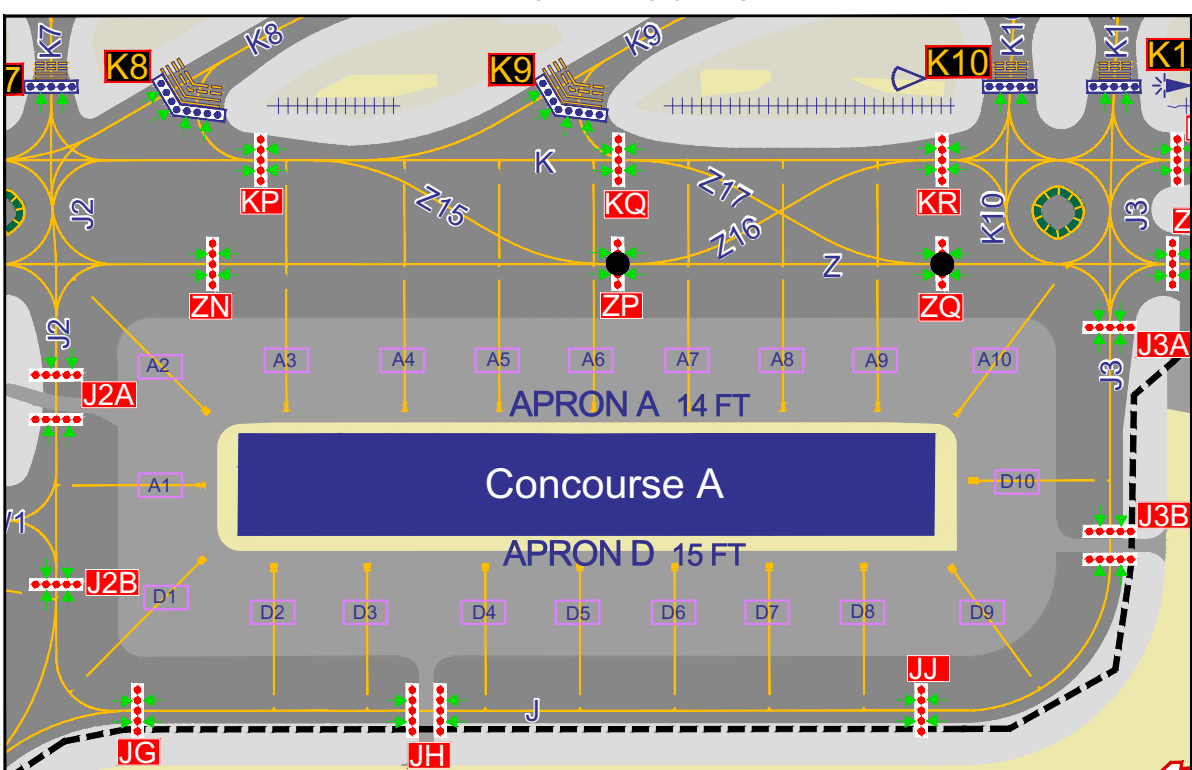

APRON ALPHA			
STAND	LATITUDE	LONGITUDE	ELEV (FT)
A1	251441.50N	0552209.54E	13.1
A2	251443.33N	0552210.90E	12.5
A3	251442.15N	0552213.18E	14.5
A4	251440.27N	0552216.56E	14.8
A5	251438.77N	0552219.27E	14.8
A6	251437.26N	0552221.98E	14.8
A7	251435.76N	0552224.69E	14.9
A8	251434.26N	0552227.40E	14.9
A9	251432.76N	0552230.11E	14.8
A10	251431.40N	0552232.27E	15.2

APRON DELTA			
STAND	LATITUDE	LONGITUDE	ELEV (FT)
D1	251439.62N	0552208.25E	13.8
D2	251438.36N	0552210.15E	14.5
D3	251436.88N	0552212.82E	14.7
D4	251435.00N	0552216.20E	14.8
D5	251433.50N	0552218.91E	14.7
D6	251431.99N	0552221.62E	14.7
D7	251430.49N	0552224.33E	14.8
D8	251428.99N	0552227.04E	14.8
D9	251427.55N	0552229.47E	14.8
D10	251429.49N	0552231.51E	14.8

For ATS Communication facilities refer to OMDB-AD-2-21
 For Aircraft Stands Restrictions refer to OMDB AD 2.8.6

APRON SIERRA

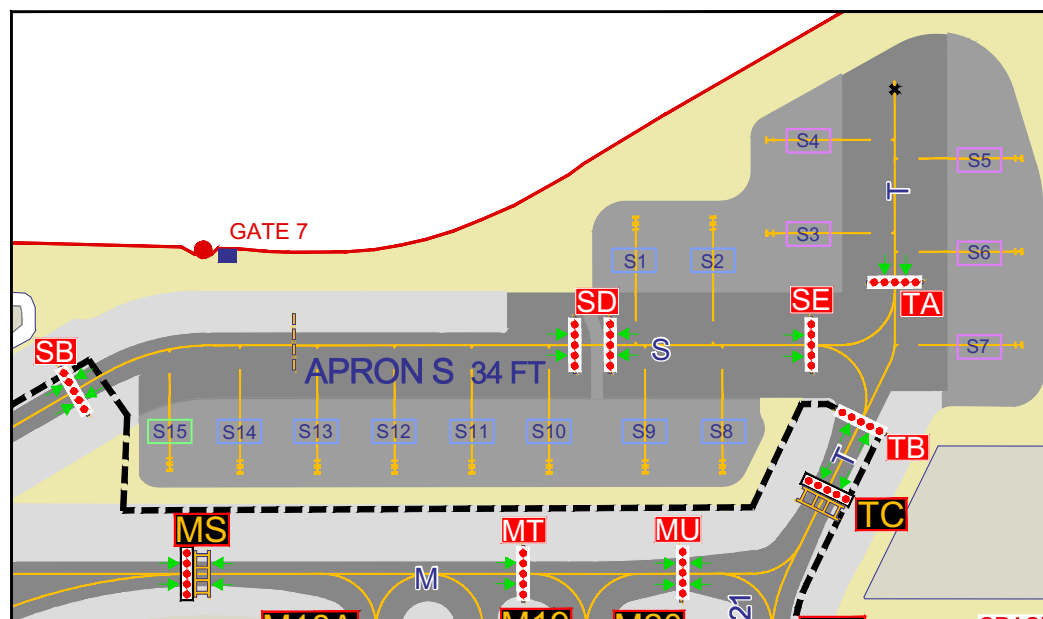

- NOTES
- It is incumbent on pilots to obtain pushback approval from ATC and to relay such approval to their ground engineer prior to commencing pushback.
 - B18L, B21L, B26L & F26L Code E Aircraft and below B18R, B21R, B26R & F26R A380 Aircraft only
 - Aircraft stands A1, A10, B15 to B27 (including B18L/R, B21L/R and B26L/R), F5, F17 and D1 to D10 has less than 3.75 M clearance, from the aircraft tail to the apron safety line at the rear of stand.

APRON SIERRA			
STAND	LATITUDE	LONGITUDE	ELEV (FT)
S1	251421.16N	0552356.37E	32.7
S2	251419.94N	0552358.58E	33.6
S3	251418.66N	0552359.81E	34.5
S4	251421.09N	0552401.44E	32.3
S5	251416.54N	0552408.45E	33.8
S6	251414.11N	0552406.82E	36.3
S7	251411.68N	0552405.20E	38.9
S8	251413.10N	0552354.37E	38.3
S9	251414.33N	0552352.15E	36.1
S10	251415.85N	0552349.40E	34.4
S11	251417.08N	0552347.19E	33.4
S12	251418.30N	0552344.98E	32.5
S13	251419.53N	0552342.77E	31.6
S14	251420.76N	0552340.56E	32.8
S15	251421.94N	0552338.59E	34.4

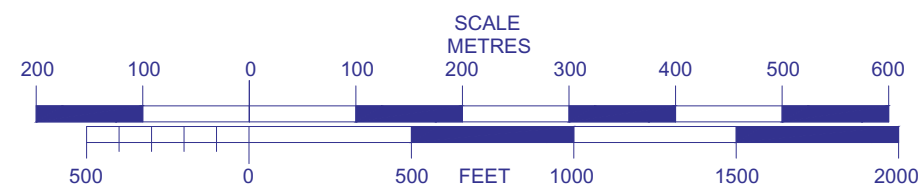

APRON DATA		
DESCRIPTION	SURFACE	STRENGTH
ALPHA	Concrete	PCR 980/R/A/W/T
BRAVO	Concrete	PCR 980/R/A/W/T
DELTA	Concrete	PCR 980/R/A/W/T
FOXTROT	Concrete	PCR 980/R/A/W/T
SIERRA	Concrete	PCR 980/R/A/W/T

LEGEND	
RVR	▶
ILS - GP, LOC	⊙
DME	⊠
LGTD WDI	▶
FOD Fence	+++++
Buildings	■
IHP	---
IHP Designator (Full Stopbar)	UD
RWY HLDG PSN Pattern A	■
RWY HLDG PSN Pattern B	■
RWY HLDG PSN Designator	K2
AD Boundary	—
Airside/Landside Gate	●
Stand CODE D	□
Stand CODE E	□
Stand CODE F	□
IHP Stopbar	●●●●
RWY Hold Stopbar CAT I	■●●●
RWY Hold Stopbar CAT II/III	■●●●
IHP Without Signage	●
Traffic Direction	▶
ATC Service Boundary	---

ANNUAL RATE OF CHANGE 0.05° E

CHANGES: Updated Stand F16 data. Editorial.