

FATO	BRG (TRUE)	VAR	ELEV (M/FT)	THR COORD	TLOF COORD	SURFACE STRENGTH	DECLARED DISTANCES (M)		
							TODAH	RTODAH	LDAH
THR H13	128°	2°E (2017)	24.8 (81)	242514.77N 0543939.90E	NIL	ASPHALT PCR 600/F/A/W/U	300	300	300
THR H31	308°		26.9 (88)	242508.80N 0543948.32E			300	300	300

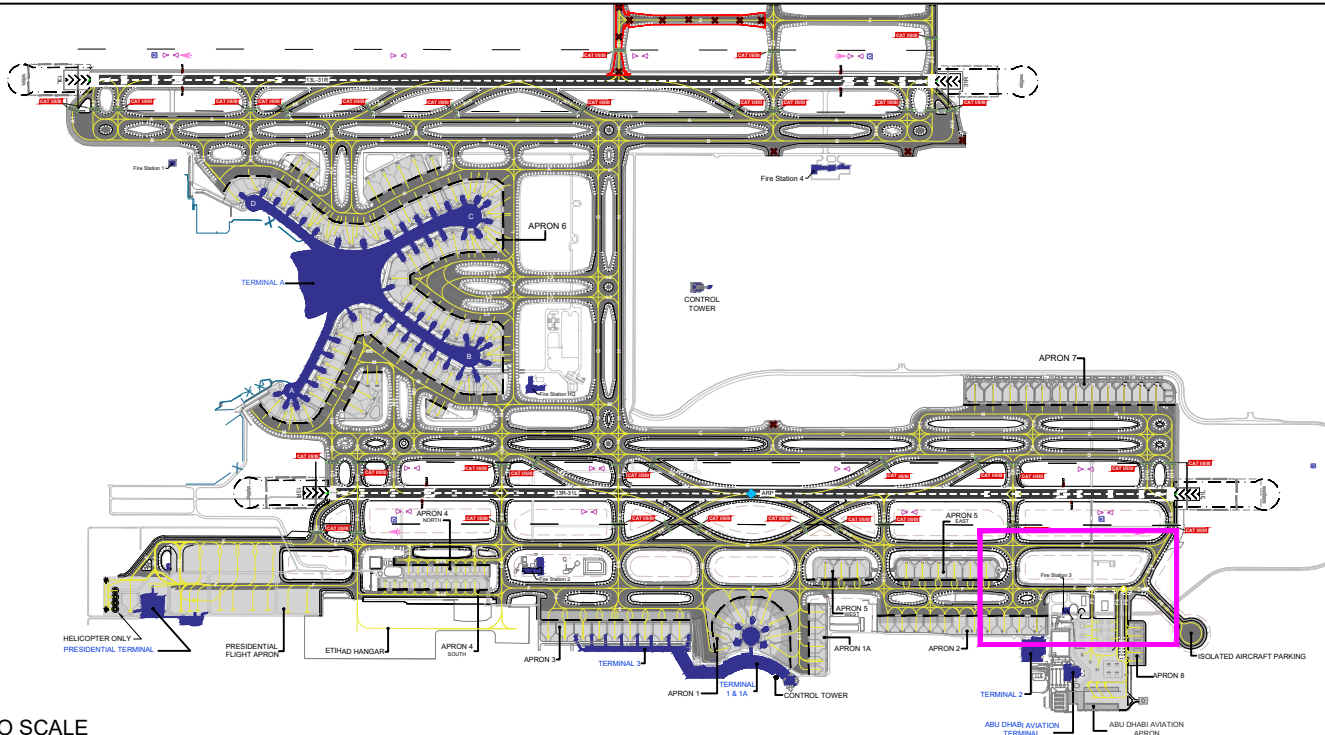

NOT TO SCALE

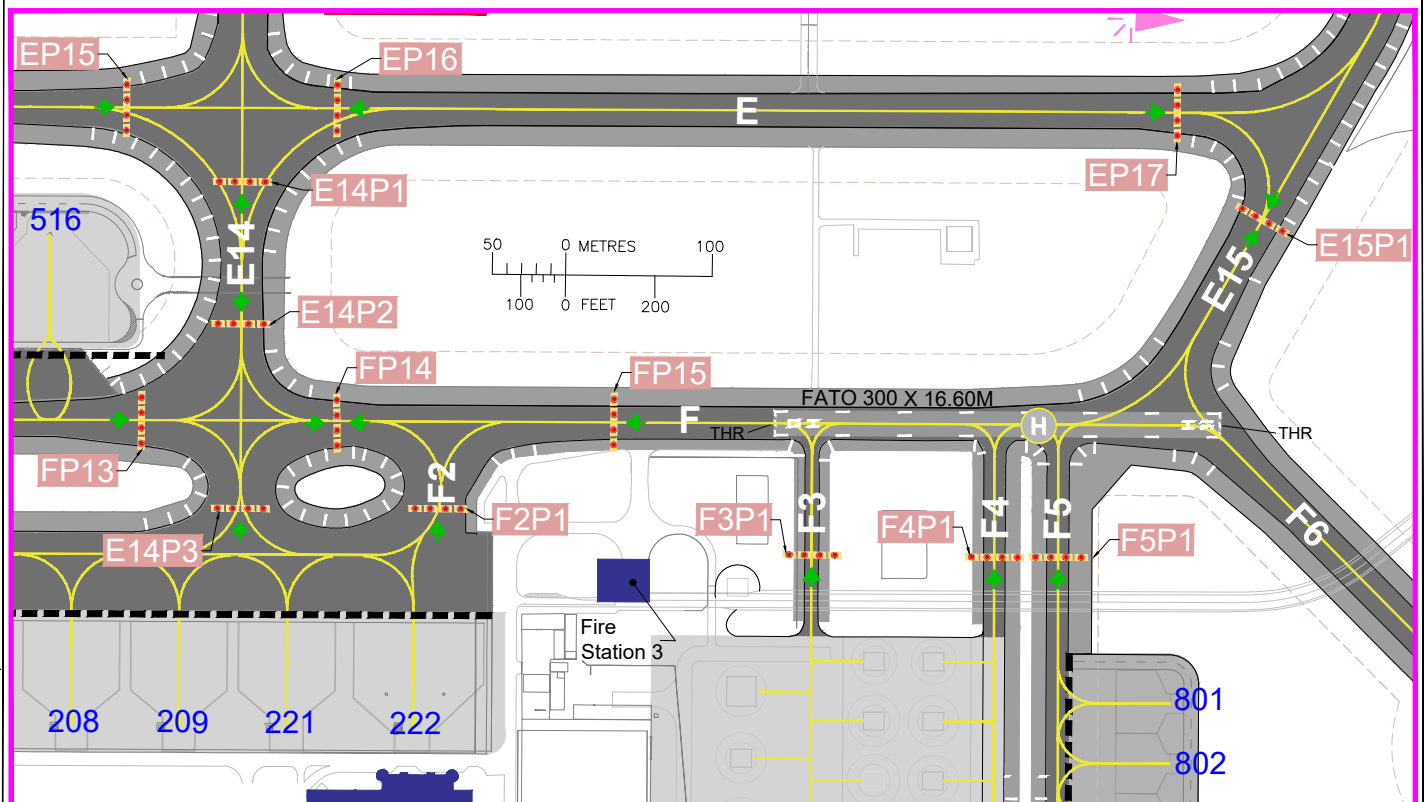

MARKING AIDS FATO H13 / H31



Remarks:

1. FATO Lighting: NIL
2. FATO is restricted to day time operations only.
3. FATO H13 is referred to as FATO 13 in ATC clearance.
4. FATO H31 is referred to as FATO 31 in ATC clearance.
5. For additional Stop bars and ITHPs information refer to OMAA AD-2-26 chart.
6. For COM FAC information refer to OMAA AD-2-21A chart.

Surface: Asphalt, PCR 600/F/A/W/U
 Safety Area: 300 X 35M
 Slope THR H13 - THR H31: -0.565 %
 Slope THR H31 - THR H13: +0.565 %

ELEVATIONS IN FEET
 DIMENSIONS IN METRES
 BEARINGS ARE MAGNETIC
 ANNUAL RATE OF CHANGE 0.05° E
 VAR 2°E - 2017

CHANGES: Relocated RHP at TWY D10 & TWY D11. Reopened TWY D between TWY C4 & TWY D10. Amended TWY CL at TWY D; ITHP E15P1 traffic directions. Removed RHP from TWY D. Editorial.